



Total Solution for DENGUE Test

Dengue COMBO Test, Dengue NS1 Antigen Test and Dengue IgG/IgM Test

Dengue Combo Test

Simultaneous Dengue NS1 + IgG/IgM Test

Excellent diagnostic tool for Dengue infection during all stage

- Complementary Dengue NS1 Ag, IgG and IgM
- No limitation of single test
- Fast result and Room temperature storage
- Available whole blood, plasma and serum
- High accuracy: 98.6% (NS1 Ag) and 98.6% (IgG/IgM)

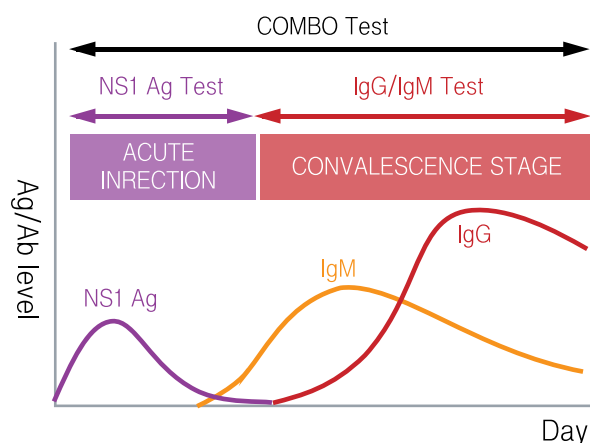

Dengue IgG/IgM Ab Test



Dengue NS1 Ag Test



Dengue COMBO Test



How to test

NS1 Ag Test

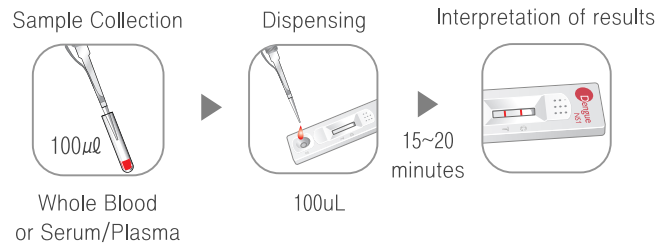

IgG/IgM Ab Test

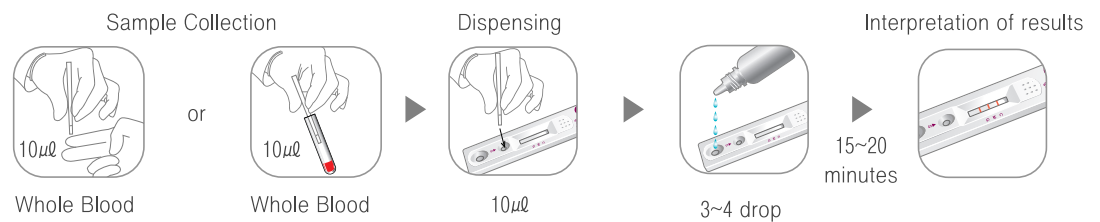

Combo Test

NS1 Ag

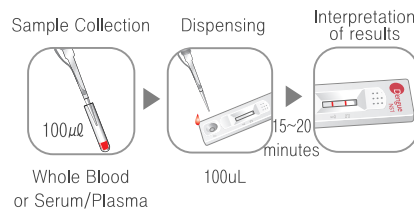

IgG/IgM

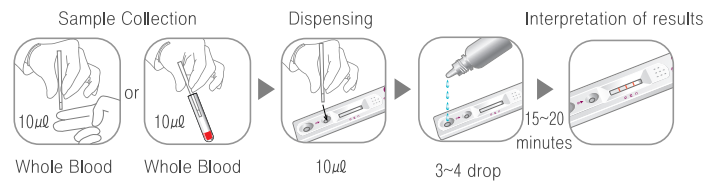

Specifications

| Product | CAT No. | Packing | Specimen | Result within | Storage | Shelf Life |
|-------------------------|-----------|----------|--|---------------|---------------------|------------|
| Dengue Combo Test | ADEC-5025 | 25 Tests | W/B, Serum, Plasma NS1 Ag: 100µL IgG/IgM: 10µL | 15~20 minutes | 1~30°C (34~86°F) | 24 Months |
| Dengue IgG/IgM test | ADEN-7025 | 25 Tests | 100µL of W/B plasma/serum | 15~20 minutes | 1~30°C (34~86°F) | 24 Months |
| Dengue NS1 Antigen Test | AEDG-7025 | 25 Tests | 100µL of W/B plasma/serum | 15~20 minutes | 1~30°C (34~86°F) | 24 Months |

Ordering Information

Humasis Co., Ltd.
Rm.504, SHINWON VISION TOWER,
88, Jeonpa-ro, Dongan-gu, Anyang-si,
Gyeonggi-do, 14042, KOREA
TEL: +82-31-478-8591
FAX: +82-31-478-8586
Email: question@humasis.com
www.humasis.com

EC REP MT Promedt Consulting GmbH
Altenhofstr. 80
D-66386 St. Ingbert / Germany
TEL: +49 6894 - 58 10 20
FAX: +49 6894 - 58 10 21
Email: info@mt-procons.com
www.mt-procons.com